

# Attic Applications

## Attic Floor / Attic Blanket

### Low-E™ Attic Floor Insulation - Floor Application (with mass insulation)

Low-E™ Attic Blanket Insulation

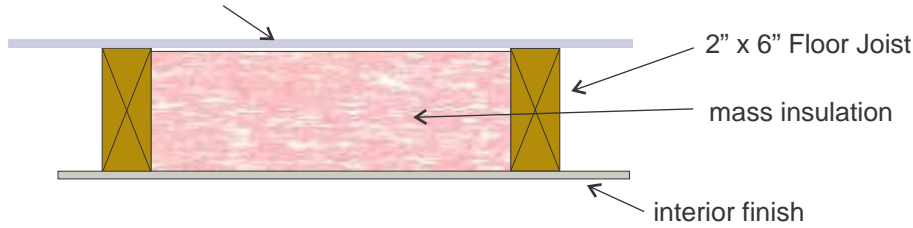

Low-E™ Attic Floor can be rolled out over existing mass insulation. The product is perforated and will not trap moisture. Low-E™ Attic Floor can be stapled with 1/2" staples every 6". Since it is not a vapor barrier taping of seams is optional.

Low-E™ Attic Floor Insulation 4' width

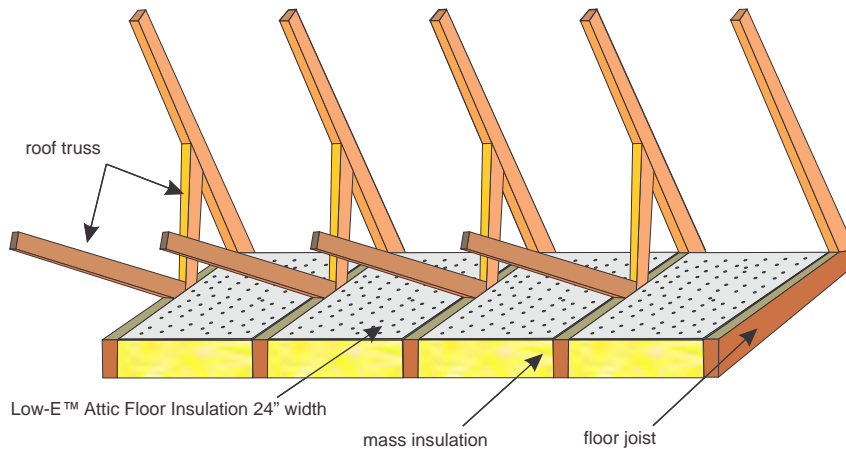
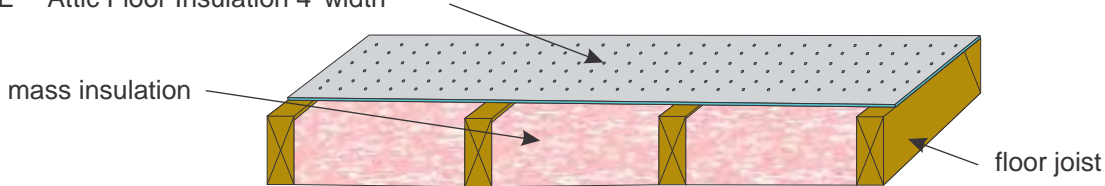

## Attic Rafters / 1/8" Low-E Insulation

Lattice Strips for additional support

### Low-E™ Roof Rafter Installation

\*Do Not Use Attic Blanket In Rafter Applications

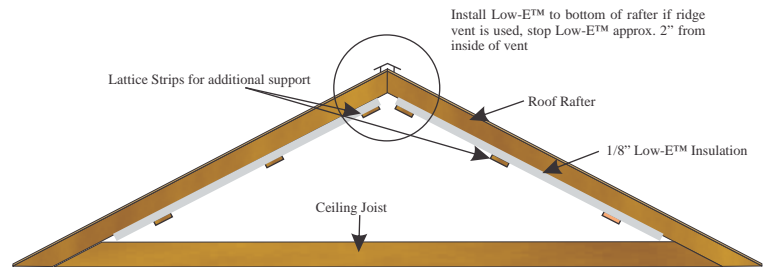
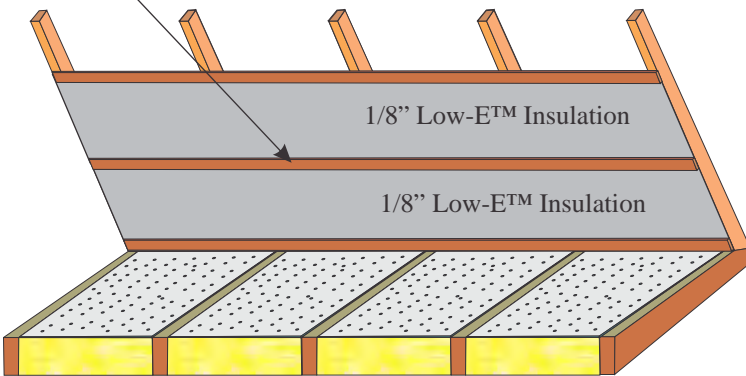

Note: If pre-manufactured truss assembly is used, retro fit between trusses with Low-E™ 16" / 24" Tab Material to avoid bracing cuts.  
\*\*\*\*\*NEVER BLOCK SOFFIT OR GABLE VENTS!

This installation below is for retrofitting rafters as an energy upgrade. Low-E™ Insulation is installed across the bottom face of the rafter. Proper ventilation must be maintained. Measure rafter area to determine square footage of Low-E™ Insulation required (length x width). Roll out material and fasten to bottom of rafter face with 1/2" staples approximately every 6 inches. We suggest starting at the peak and working down to the eave. Leave approximately 1/2" space at the peak for ventilation. All adjoining seams must be taped securely with Low-E™ tape, unless a staple flange product is used. To prevent insulation from falling from rafters, ESP® Low-E recommends using lattice strips for added support.

Note: Drawings are not to scale and are meant to depict possible applications. Exact Specifications may vary.